



2016 Annual Flying Star Cures

ELLIOT JAY TANZER

author of Feng Shui Secrets: Improving Health, Wealth & Relationship Harmony

310-281-6798 • P. O. Box 891924, Temecula, CA 92589 • et@ElliotTanzer.com • www.ElliotTanzer.com

Gong Xi Fa Cai - May Your Year Be Fortunate

(Summation of Cures and Enhancements for 2016 can be found on Pages 10-11.)

Writing this Annual Cures Newsletter each year has become a labor of love, growing out of my own desire to know what to do, how to do it, and how best to assist my students and clients. Each year I read and compare several reports provided by other practitioners from around the world. Some are quite basic, and others are wonderfully rich in history and in the metaphysical underpinnings that, for me, give meaning to why we do, what we do.

All master practitioners emphasize that first and foremost a home or office must have good feng shui. Though placing Annual Cures will bring some short term results, there will be little long term benefits if the home or office is a feng shui disaster. You should also be aware that Annual Cures will not effect everyone the same.

There are a lot of variables to consider, primarily your innate constitution for handling health stressors, your karma with money that enables you to handle what could be financially challenging times, your relationship harmony based on how well you have resolved your relationship issues, and so forth. Good feng shui won't make some one of low IQ a genius, but good feng shui will increase every student's ability proportionate to their capability.

Predictions can be made to what will generally effect the populace at large, but what kind of a year you will have is unique to you, and can be examined



Year of the Fire Monkey

based on your birth information. This is something I have been doing since 1973 with Western Astrology. Others, trained in Vedic Astrology, Four Pillars of Destiny, and other systems of analysis, can also describe your future trends. As all systems are glimpses into the holographic whole, the guidance and insights should be similar in accordance to the skill of the reader.

Teaching Schedule for 2016
To find out about upcoming feng shui teleseminars and practitioner trainings, including special workshops on how to integrate Compass School techniques with Black Sect skills, email me at: et@ElliotTanzer.com.

When I do Future Forecasts, I think of it as similar to a Road Map indicating road conditions. If there is a 'bumpy' stretch ahead, it is best to slow down to avoid 'bottoming out' and putting a hole in our gas tank; or when conditions are favorable, we can put 'pedal to the metal' and zoom effortless and unde-

tered along our merry way. The concept is: forewarned is forearmed. Ideally, this should enable you to go with the flow as a co-creator of your destiny, instead of bouncing along totally unaware and out of control.

Solar and Lunar Calendars

Many countries in the Orient use two calendars. The Lunar Calendar is used for ceremonial purposes and, in the Stems and Branches 60-year calendar system, determines the Animal (Branch) and Element (Stem) of the year. It is this Lunar New Year which you are all familiar with from place mats at your favorite Chinese restaurant. This calendar begins on the second New Moon after the Winter Solstice, which this year falls on **February 8**. And then there is the Solar Calendar.

It is the Solar Calendar which is used in Xuan Kong (Time-Space) Feng Shui, especially when using the Flying Star (Fe Xing) method, that determines the important feng shui adjustments that are needed as the earth's magnetic field shifts at the beginning of each Spring.

The Chinese Solar New Year begins in the Orient on Feb. 3 or 4. It is this day that is considered the beginning of Spring, as it is about mid-point between the Winter Solstice and the Spring Equinox.

2016 - Year of Yang Red Hot Fire Monkey - Bing Shen

Monkey Year people, not too surprisingly, tend to be clever, agile, glib, exciting, sometimes mischievous and easily distracted, with the greatest challenge, staying focused and on purpose, while cautiously

avoiding scammers and deceptions.

As the ninth animal sign in the Chinese 12-Sign system, Monkey often moves fast and takes big risks, favoring innovative entrepreneurs and revolutionary ideas, with attention needing to be paid to details, or else accomplishments will be short-lived.

As this is a Fire year, the Fire Element will enhance the productivity of the Monkey, it can also bring unruly, unethical and even offensive behavior in those so inclined.

Animal Signs favored this year are the Monkey's friends Dragon and Rat with most other Animal Signs doing well enough, if they do not let wily Monkey throw them off balance. Those who do not get along well in Monkey Years are those born in Tiger, Horse, Dog, or Pig Years.

If you were born in an Animal Sign that conflicts with the Monkey, it is recommended that you wear a protective amulet of either your Animal Sign friend, or one featuring a **Pi Yao charm** on a necklace, key chain, or hanging from your rearview mirror. Pi Yaos make great protectors, as they are loyal and will sacrifice themselves to protect the well-being of their owner.

In making Monkey Year predictions consider the Monkey is Yang Fire (Branch) over year element Metal (Stem). Unlike 2015, a Yang Fire year, encourages business investment, taking initiative, social engagement, travel, scholarship, curiosity and revolution (1776 was a Fire Monkey Year). It can also be a year of assassinations by those delude by religious dogma or political demagoguery. Monkeys are tricksters and are also those who are easily tricked.

Xuan Kong Feng Shui - 2016 Annual Number 3

There are many approaches to feng shui. The first and most important is evaluation of the Landforms and Qi Flow to, through, and around a location – the subject of my book, **Feng Shui Secrets: Improving Health, Wealth & Relationship Harmony** (previously titled: **Choose the Best House for You: The Feng Shui Checklist**).

2016 Lo Shu – Annual 2

SE	S		SW	
	White 1 Water	White 6 Metal	White 8 Earth	
E	Purple 9 Fire	Black 2 Earth	Green 4 Wood	W
	Yellow 5 Earth	RED 7 Metal	Jade 3 Wood	
NE	N		NW	

Many of you are familiar with the Bagua as a method of 'mapping' the home or office by designating certain areas as being a focal point for Abundance, Relationship, Career, and so forth – what is often referred to as the Eight Aspirations. In this system we place various items that symbolize these aspirations.

A more traditional approach uses a compass to determine the magnetic field of a location as seen in cycles of 20-Year Periods. There are nine periods equalling 180 years. Since Feb. 5, 2004 until 2024, we are now in Period 8.

Within each of these 20-Year Periods, each year is also governed by an energetic pattern referred to as the Annual Number. The Annual Number for 2016 is #2. The #2 determines how the other numbers, representing various Elemental types of energy, or Qi, 'fly' according to the energetic sequence described by the Lo Shu Magic Square (above). It is these numbers, representing the Five Elements (Wu Xing) that determines which areas of the house may or may not be enjoying good fortune.

MAINTAINING BALANCE

Consider if you were to weigh something on a balance scale with one side being heavier than the other. You add a little counterbalance to one side or another and eventually bring the scale to equilibrium. Or like a shower faucet, if the water flow is too hot, add a little cold until it is just right.

Five-Element Theory – Wu Xing

- The Five Elements are not 'things' as much as processes, e.g. Wood is the process of growth – too much Wood Element, may be a business that has problems as a result of 'growing too fast'.
- Realize the numbers in the Lo Shu (to the right) are essentially a code for the Five Elements and their attributes such as: compass direction, body parts, personality types, kinds of career, seasons (colors), and so forth. The code is:

1 – Water
2-5-8 – Earth
3-4 – Wood
6-7 – Metal
9 – Fire

- The suggested remedies and enhancements are traditional Chinese artifacts, which can be substituted with objects from your own culture or that conforms to your interior design preferences. Ex: Kuan Yin may be suggested as a symbol of peace, compassion, and protection. A Metal Kuan Yin can drain Earth 2 or 5, while a Red Kuan Yin can burn up Wood 3. In this way the Element is combined with an item that symbolizes something positive. But anything made of metal will drain Earth, and even a red piece of paper will burn up Wood.
- Remedies for inauspicious numbers that reduce or drain its influence: Metal reduces Earth; Water drains Metal; Wood uses up Water; and Fire burns up Wood; and Earth reduces Fire.
- In order to benefit from the auspicious numbers enhance with the **same** Element or the Element that feeds it: Metal feeds Water; Water feeds Wood; Earth feeds Metal; Fire and activity feeds Earth; and Wood feeds Fire.

Water: dark colors, amorphous shapes, detailed patterns, water features, images of water.

Wood: green, columnar, stripes, items made of wood.

Metal: grey, white, metallic tones, circles and domes, items made of metal.

Earth: beige, earth tones, square, solids, items made of earth.

Fire: vibrant colors, triangles, candles, bright lights, lead-glass crystals.

Now comes the Annual Elements with some bringing positive, and others bringing negative, influences. In some cases the balance is unaffected, and in some the balance is tilted radically askew.

It is this need to maintain equilibrium that dictates which remedies to apply to rebalance the negative 'tilt', and which enhancers should be considered to maximize the auspicious potentials.

By analyzing where these energies fall, using the Creative, Reductive, or Controlling Cycles according to Five-Element Theory, we can neutralize the negative energies and enhance the positive ones. Below is a description of what to do.

NOTE: As feng shui was developed by the Chinese over thousands of year, many of the solutions have Asian themes. However, you may substitute other items that you feel will achieve the same results.

It should also be understood that as feng shui has traveled from China to many new locales, different practitioners have developed differing methodologies to achieve harmonious results. Having learned their methods in some isolation from other practitioners, some feng shui experts may sound authoritarian about 'how it should be done.' Remember, no one gets 100% good feng shui, probably because no one system has all the answers.

Consequently, we in the Occident have a wonderful opportunity to hear what all teachers have to say, and to choose what we experience as working best for us. Try to be flexible during your learning process, do what resonates with your sensibilities, and do not follow any one method blindly. Most important, observe the results and modify accordingly.

Empower Your Cures and Enhancements

I am sure many of you reading this are already quite evolved in your own spiritual cultivation and maturity, and are quite capable to bless and energize your cures and enhancements by either placing on your home altar, or silently tuning in and seeing all items energized.

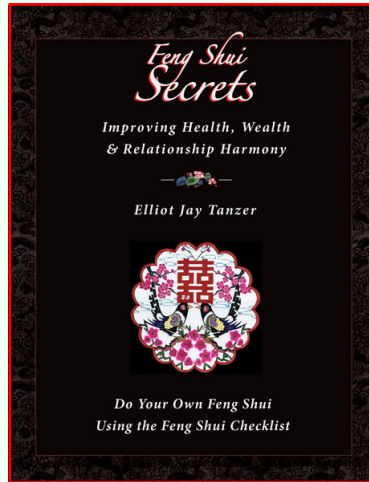

ISBN #978-0-9743008-4-9
8 1/2 X 11 • 152 pages • \$19.95

3rd Revised Edition – previously titled:
*Choose the Best House for You:
The Feng Shui Checklist*

This is the most comprehensive list of feng shui problems and solutions related to property, house construction and room configuration with special sections on the entrance, bedroom and children's room.

The innovative checklist format makes it easy for anyone to evaluate a home's good fortune. A valuable resource for feng shui students and practitioners. A guidebook for real estate agents, home builders and interior decorators.

**Order your copy today
at www.luckycat.com/cures**

An excellent Gift for someone you love.

You can also energize each item by holding the item in the palm of one hand with the palm of your dominant hand over the item. Tune in, recite a prayer or blessing to "program" the item to fulfill its purpose – as they say, to "Anchor your Intention." Wait until you feel the item enliven with the transference of Qi, then respectfully place it in the new location.

Cleanse or Dispose of Old Cures

Before the beginning of the Solar New Year on Feb. 4, cleanse all cures, such

as Wu Lus (gourds), Pi Yaos (dragon-headed four-leggeds), Wind Chimes, and many of the other cures used the previous year. There are some practitioners who suggest all cures used the previous year should be disposed of, while others feel this is a bit extreme. Almost all practitioners agree, however, that it is best to completely dispose of Bagua Mirrors and Salt Water Cures (described below) as they are full of negative energy.

Some authorities suggest previous year cures should be cleansed by leaving them exposed to the Full Moon over night, others place them in direct sunlight for at least four hours. Some say you should sprinkle the previous year's cures with **Sea Salt**. Cleanse according to your tradition.

Installing Cures

Once items are cleansed, they should be put in their new positions by Feb. 4. Some people put their cures into place before Feb. 4, but **anytime during the year is better than not at all**. Once cures are in place, it is said that it takes about a month for them to absorb any negative energy being generated by the negative numbers and to enjoy the benefits of the enhancements put into place to enhance the positive numbers.

But whatever you do, don't worry if your bed, front door, or office are in those areas considered "afflicted" this year. By placing your feng shui cures and enhancements in the right Sectors, you will bring balance to your home or office, so you can continue to enjoy good health, great prosperity, and relationship harmony.

However, if after placing the Annual Cures you begin to experience difficulties regarding finances, health, relationships, or any other area of life, remove, readjust, or add additional cures according to the suggested placement, and then observe again. Flying Star cures for the house are done once. Annual Cures are for short term results and might need adjusting.

Note: Consulting with a professional feng shui practitioner may be beneficial to evaluate the outside Landforms and the

Flying Star number combinations which were in effect when the home or business was built. If you would like to learn how to do a Flying Star analysis, my *Tutorial for Using the Master Formula Study Guides*, along with my three laminated Study Guides, will explain each formula needed, and how to interpret the results (see p. 15).

Work With Your Floor Plan and Use an Accurate Compass

As you read through the following recommendations, it may be easier to do so with an accurate floor plan of your home or office in front of you. You can divide the floor plan using the traditional 9-Box Grid method or the 8-Spoked Wheel method (as seen to the right) preferred by many modern masters. (See page 14 on how to place the compass directions on a floor plan using my perforated See-thru 8-Spoked Wheel Tracing Compass.) Whether using the Grid or Pie method, mark each sector with the appropriate compass direction, and then fill in the recommendations.

If you do not own a traditional lou pan (feng shui compass), any good hand-held compass will do that has ALL 360° clearly indicated. (Avoid compasses with degrees in 2° or 5° increments and smart phone compasses).

The illustration above uses the 8-Spoked Wheel method, and is an example you might want to follow. This will assist you in making your shopping list. Then, when you gather your remedies, you will have a clear reminder as to where the cures and enhancers should be placed, and where to find them again at the end of the year before you relocate them the following year to their new locations.

You can also divide a specific room or large space, such as your office or warehouse, and place remedies in the appropriate compass directions of a room.

Note: Cures listed are suggested choices. Use one or more. If you use one with no apparent result, add another.

Cures can be put in the appropriate compass direction of the house, and or in the corresponding corner of any room, especially in one's office.

Note: Not all Cures listed need to be used. The Cures listed are suggested choices.

Lou Pan Compass

AVOID WATER & WOOD
SH. WOOD WULON
RED LAMP SHADE
RED CANDLE
RED TASSELS NW ③

7 LUCKY BAMBOO
BLUE CRYSTAL
BLUE RHIN ⑦

AVOID METAL & EARTH

NO FIRE OR EARTH
SOLID BRASS INGOT
SALT WATER CURE
& ELEMENT

7-TIGER PAGODA
CALLIGRAPHY PEN SET

DRAGON ④ NW
& PHOENIX
MANDARIN DUCKS

247.5
↓ SW ③

232.5
↓ SW

GRAND DUKA
RED FROG w/ COIN

SALT LAMP
FRESH FLOWERS

MOVING & WATER
CINNABAR
EGG

3 KILLING
④ SW

SE ⑥
NON-METALIC GOLD
BUDDHA
TORTOISE w/ COIN
COIN RULER

12-COIN BALL
10-Coin tied w/ Red STRING
BEJEWELLED FIGURINE
METAL SINGING-BOWL

② CENTER BRASS WULON
SALT WATER CURE
6-COIN ON RED STRING
6-COIN BALL/NO FIRE OR EARTH

9-FISH SCROLL
CORAL GEN TREE

E ⑨ AMYTHYST
9 Gold INGOTS
9 LUCKY BAMBOO
AVOID EARTH

YEAR 52-5 PI-YAO
BREAKER
67.5
FACES
SW ③ ←

Whether the 9-Box Grid or 8-Spoked Wheel method, use the one that is easiest for you. To use the 8-Spoked Wheel method see page 14 for how to obtain a Tracing Compass that makes it easy and accurate.

Feng Shui Cures and Enhancements for 2016

First, we will look at the inauspicious Stars which require cures to neutralize their potentially negative influences and which, if possible, you do not want to disturb with activity. If you can use another room, it is advised. If you need to use any of these areas, don't worry! Just be sure to put the suggested cures into place and observe results, making appropriate adjustments as needed.

K'un = 2 Black Earth in Center "Star of Illness"

The first difficult number (Element) that needs reducing is the 2 Black Earth which this year is found in Center sector of the house. The #2 makes this an area of potential illness (especially stomach ailments), and misfortune in 2016. So take extra care to neutralize the #2's potentially malicious influence.

As with 5 Yellow mentioned next, it is

best if you do not have to use this area of the home. If you do have to use this area, be sure to use the cures listed below to neutralize their negative influences. If you are lucky to have a bathroom, utility room, or lesser used room in the Center no cure is needed.

Wu Wang - 5 Yellow Earth in NE "Star of Misfortune"

With Annual Star 5 in the NE this year, 5 Yellow (Wu Wang), considered malicious, as it is **not** associated with a gender or trigram, is somewhat strengthened by Earth Element associated with the NE. If possible, do not use any room in the NE. If there is a bed or desk in this sector of the home or room, consider if you can relocate to a better sector, if not, trust your remedies to maintain harmony.

The following cures are recommended to protect prosperity, relationships and health: As 'moving' Metal reduces the negative effects of the 5 Yellow Earth,

a **6-Tube Wind Chime** or a **Pendulum Clock** (with a metal pendulum) is placed wherever the 5 Yellow is found. You can also place a brass **Five Element Pagoda** in this area filled with earth taken from near the home or office to 'lock' the negative Earth energy up. Also place round, coin-shaped objects.

Other additional cures also recommended for controlling the negative influences of both 5 Yellow Earth and 2 Black Earth are as follows:

Cures for 2 Black and 5 Yellow:

- In both the Center and NE, put **6-Coins** tied together with a red cord to weaken #2 and #5 and to protect wealth, especially if #5 is at the front door. A **Solid Brass Ingot, Brass Dragons**, or a metal statue of **Kuan Kung** (Wealth God), can also be placed in either the Center and NE to protect prosperity.
- If the #2 or #5 is in a bedroom, a small heavy **Brass Wu Lu** can also be placed next to the bed (larger the better). The Wu Lu's nickname is 'the Giver of Life.'
- Many practitioners feel the **Salt Water Cure** is the most effective cure for #2 and #5. Some practitioners use an open bucket, while others suggest a 12 to 16 oz. urn with a perforated covering. Which ever you choose, fill it 2/3 with rock salt and place 6 copper coins - traditional Chinese coins with heads facing up, and a silver coin (optional) on top (real copper and silver, not alloys). Then fill the urn with water. Though a Salt Water Cure for the home's Flying Star birth chart can be covered with gauze or

plastic wrap secured with rubber band or twine, and with holes large enough to allow the urn or bucket to "breathe" and yet not evaporate too rapidly, it is best to leave Salt Water Cures used for Annual #2 and #5 uncovered, so it can absorb as much negativity as possible. Though this Cure can be placed out of view, **DO NOT** put in cupboard. Be sure to place a mat beneath to protect your furniture from the salt encrustation that builds around the outside of the urn. At the end of the year this cure, urn, salt, coins and water should be disposed of by placing the old materials in a sack and dumping them in the trash. New materials should always be obtained for the current year's use. Remember, one Salt Water Cure in the Center and the other in the NE.

- If the front door is in either the Center or NE, a **Bagua Mirror** should be hung outside above the door to deflect the incoming Sha ("killing") Qi. Other objects of metal, especially round in shape or metallic colors, should be placed inside near the front door. Oil the hinges and avoid slamming the door.

- As the Fire Element enhances Earth, avoid using bright lights, red colors, burning candles, or playing loud music. If there are already red colors in this area, either remove them, or add more Metal images or objects to maintain balance.

- If you have to work around the outside the home in the NE, hang a **6-Tube Wind Chime** between that area and the house. If you are working on a larger area that includes the Center or NE, do not be concern as long as the Center and NE,

is not the focal point.

- Use **Metal Singing Bowls** or **Tibetan Tingsha** (cymbals) once in awhile to disperse the negative energy of the 2 and 5.

Year Breaker (Sui Po) in NE3

Sui Po, the Year Breaker, is always in the 15° opposite the direction of Tai Sui. This year Sui Po will be in the NE3 Sector between **52.5° to 67.5°**. As this year Sui Po shares a portion of the NE with usually unfortunate Star 5, this is another reason this direction should not be disturbed with remodeling or other disturbances in the home or digging and loud noises outside.

Unlike Tai Sui, which it is advised you avoid confronting by facing in Tai Sui's direction, as with the Three Killings located in the West this year, it is best to face the direction of Sui Po in the NE, and thereby benefiting from having Tai Sui in the SW.

Zhen - 3 Jade Wood in NW "Star of Arguments"

Though the #3 is not a timely number, it is said to be usable in Period 8. Even so, it is still wise to be cautious, as #3 is not inherently a fortunate energy, and can bring short tempers, arguments, legal problems, divorce, and so forth. As with any negative influence, minimize use of this area and postpone remodeling.

Avoid placing any objects made of metal in this area as Metal destroys Wood. Avoid adding water or watery colors or symbols, as Water nourishes Wood. In fact, it is advisable to remove



Wealth Vase



Non-metallic Gold Buddha



Amethyst Gem Tree

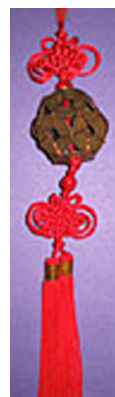

8-Coin Ball



Porcelain Kuan Yin



Metal Kuan Kong (Wealth)

water features that may have been placed there in previous years.

It is best to reduced #3 Wood Element using the Fire Element, as Fire “consumes” Wood. So burn candles, use bright lights, hang a lead-glass **Crystal Sphere**, place accessories that are red, like **Red Tassels**, lamp shades, objects that are triangle-shaped, or even a red piece of paper. A **Red Kuan Yin**, representing peace and compassion, or a **Red Laughing (Ho Tai) Buddha** can be used to transform the negative Qi of #3 Jade Wood.

You can also put your **12-Coin Ball tied with a Red Ribbon** in the NW to guard against financial lost. If the NW is the direction of your front door, hang a new **Bagua Mirror** over the door to deflect any negative incoming energy.

Dui – 7 Red Metal in North “Star of Robbery”

The #7 was consider fortunate when it was the previous Reigning Period Star – 1984 to 2004. Since Period 8 began, Feb. 4, 2004, the #7 has declined in influence, becoming a negative influence representing violence and robbery.

If the #7 Star is in the kitchen, there needs to be caution against fires. So check smoke alarms and home fire extinguishers. If you have an office in the North consider moving it, or be extra careful to double check all legal agreements.

If your front door is located in the North, be sure locks and security systems are working properly. You may want to put a new **Bagua Mirror** over the door. If your front door mat is red, you may want to replace it with one that is blue

Sixty Tai Sui

One of my most interesting new discoveries a couple of years ago was learning there are 60 Tai Sui with one Tai Sui who is in charge of all the others. This Tai Sui goes by the name Yin Jiao, who was the son of the evil King Zhou of the Shang Dynasty. Yin Jiao is usually depicted with three heads and six arms.

According to the Chinese calendar, each year is a combination of an Animal Sign and an Element, called Stems and Branches – 2016 is the Year of Bing Shen, the Yang Fire (Stem) Monkey (Earth Branch). As there are 12-Animal Signs and 5-Elements, it takes 60 years for the cycle to repeat with each year assigned a different Commander, or Lord of the Year, known in Chinese as Tai Sui, or in English, the Grand Duke Jupiter, each with their own characteristics, temperaments and abilities.



As Jupiter takes approximately a year to travel 30° and 12 years to complete one orbit around the Sun, it is the key to understanding everything from 12-Animal Signs, the 12-Double Hours of the day (ex.: 3pm to 5pm is Monkey hour), and the overall structure of the traditional Farmers’ (commonly referred to as the Hsia, or in modern Chinese, as the Xia), Calendar (12 Animals x 5 Elements = 60 years x 3 Grand Cycles is a complete 180 year cycle, or nine twenty-year Periods (in Chinese called Yun). We are now in Period 8 – 2004 to 2024.

As the Jade Emperor is the Ruler of Heaven, the year Tai Sui is the Ruler of Earth. Tai Sui is always located in the same compass direction as the Year Animal Sign, which this year is SW3 the sign of the frisky and mischievous Monkey, making the Tai Sui of 2016, Great General Guan Zhong, known for his rise from a poor family to become Prime Minister, who brought unity to the country, a unified tax code based on productivity, and improved social conditions for all the people. History considers him the ideal Confucian minister. Put the proper Remedies and Enhancements in place, and enjoy a year of progress, harmony and well-being. And vote for the candidate most like General Guan Zhong.

or other dark color. If you have a wind chime, it might be a good idea to remove it until Feb. 3, 2017.

To avoid Metal 7 danger **Do Not** add things made of Metal or Earth, as both Metal and Earth nourish the negative Metal energy of #7. Blue and dark colored accessories, along with a bowl of clean still water with six coins or three

pieces of “lucky bamboo” can be a calming influence to #7. My favorite is a **Blue Rhinoceros** figurine in the area of #7 Red Metal.

☺ Next, we will look at this year’s fortunate Stars which you want to activate in order to tap their potentially positive influences.



Pi Yao



7-Tier Pagoda



Crystal Globe



Brass Wu Lou



Wood Wu Lou w/ Red Tassel

K'an - 1 White Water in SE "Star of Relationship"

This year the position of #1 Star is situated in the SE of the home. As SE is associated with the element of Wood, **placing Metal remedies in this sector will drain and damage the Wood**, while boosting Water for prosperity and professional good fortune.

Then, to hold onto the money that comes in some authorities recommend a **Bejeweled Dragon-headed Tortoise**. Actually, any money enhancers should do the job: such as the **12-Coin Ball** with a red tassel, a **Brass Ingot**, and anything else made of solid metal, such as a **Seven-Tier Pagoda**, or a **Gold Arowana Fish** figurine, as Metal nourishes Water.

A **Brass Wu Lou** or other metal or round objects beside the bed will be beneficial. Blue dark colored, or heavily patterned interior design touches are encouraged to stimulate the Water Element. Avoid adding Wood Element colors or shapes as these will drain the auspicious potential of Water Star 1.

Xun - 4 Green Wood in West "Star of Intelligence, or Romance"

Given the prominence of the West of the home, any enhancement placed here will boost opportunities for career improvement or travel, especially if the front door of house or office is situated in this sector.

Still water is an especially good way to attract prosperity, but the water must be kept clean, whether in a vase with fresh



6-Tube Chime 9-Fish Scroll 3-Coin 6-Coin

flowers, or with four Lucky Bamboo in the bowl. An office in the West is especially auspicious for writers and other creative professions.

If the #4 is in the bedroom, use a wood **Kuan Yin**, relationship images like **Mandarin Ducks**, which mate for life, or a **Dragon and Phoenix figurine** will add romance and stability to relationships.

Avoid adding objects that are white or metallic tone in color, made of metal, or are round or semi-circular in shape, as Metal attacks Wood. Avoid the color red, triangle shapes, or burning candles, as Fire reduces Wood. Either remove these items, or add additional dark, watery colors, and amorphous shapes to nourish 4 Green Wood in the compass direction it is visiting.

Placing a **Crystal Globe** on a desk favors travel, a **Seven-Tier Glass Pagoda**, an **Abacus**, and or a **Calligraphy Pen Set** is excellent to benefit academic achievement as well as the creative professions. A **Gem Tree with Blue or Amethyst Stones**, a **Green Jade Pagoda**, or single quartz points can all energize #4 Wood.

Qian - 6 White Metal in South "Star of Heaven"

The sector with #6 is usually consid-

ered to be excellent for wealth and career success. Activate with fresh flowers and spending time in this area of the home.

Though you can strengthen the #6 with things made of metal, such as a **Dragon-headed Turtle** with a coin in its mouth, metal **Dragons**, or other metallic wealth images, you can also energize #6 with a lead-glass **Crystal Sphere**, or real **Quartz Sphere** or **Geod**. One or six **Hollow Gold Ingots** can be placed in the West to enhance #6 (light weight, non-metallic and gold color), 6 coins in a bowl of clear water, or a non-metallic **Gold Buddha**.

Do not burn candles, and avoid adding anything with the color of red or that is triangular shaped, as the Fire Element destroys Metal.

If the South is a bedroom, tone down #6 Metal with blue colored items, or with images of relationship harmony, such as depictions of two **Mandarin Ducks** or a **Dragon and Phoenix**.

Do Not, however, put a water feature with a water pump in the bedroom, (or any room that is located in the NE of the house, see page 9).



Mandarin Ducks



Water Fountain w/ Nine Bells



Dragon and Phoenix

Feng Shui Emporium

All items listed and illustrated in this 2016 Annual Cures Newsletter can be obtained at: www.luckycat.com/cures.

I highly recommend this website as it is one of the few that has the variety and the quality. It is the best one-stop online shop for all your feng shui needs and quality feng shui supplies.

Take your time deciding which of the 2016 Cures you need and where it needs to go. Then make a list and paste:

www.luckycat.com/cures

in the subject line of your browser, and happy shopping.

Each item is expertly chosen, handled, and packaged with care. And they are located in the U.S. of A.

Three Killings (San Sha) in South

Unfortunately, this year the #6 Star shares the South with the Three Killings.

However, the Three Killings should not be a problem if the proper remedies are put into place. Most of all, in contrast with the 15° of the Grand Duke in the SW (232.5° to 247.5°), avoid sitting with your back to the direction the Three Killings are occupying for the year.

That is, it is best to face the Three Killings. This does not include occasional sitting, but those places that you frequently sit, such as at your desk or work station. If this is impossible to change the direction you sit, put at least two **Qi Lin** (also called Chinese Unicorns often sold in pairs) on your desk facing the Three Killings for protection from financial loss, sickness and arguments. I prefer three **Qi Lin**, which I purchased separately, and then placed on a teak wood display stand. Another good choice is to use a combination of the **Three Protectors (a Fu Dog, a Pi Yao, and a Qi Lin)** with all three placed side-by-side and facing South this year.

[For those who are curious how the Three Killings direction is determined, it is always in the Cardinal direction opposite the Year's Animal Sign. That is, 2016 is the Year of the Monkey, which resides in the SW. The Monkey is part of the Trinity of Friends, which includes the Dragon (SE) and the Rat (North). Of the three Animal Signs only the Rat is in a Cardinal Direction, which is North. So

the Three Killings in 2016 is located in the opposite Cardinal direction which is the South.

This is similar to the formula for determining your Peach Blossom or Flower of Romance direction to attract a loving relationship. [Send me an email and I will send you the specific formula.]

Gen – 8 White Earth in SW "Star of Wealth"

The #8 is most fortunate as it is the Reigning Star until Feb. 2024. This will bring great good fortune and career recognition, especially if your office or other frequently used room is located in the SW of the home. If your front door is in the SW, or if it is not a frequently used room, **energize this sector** with something that moves, like a kinetic sculpture, CD player, oscillating fan, or chiming clock. As always, keep the entrance way clean and clutter free.

However, **with #8 Earth is supported by the Earth SW of the house**, any additional enhancements should add an extra boost to finances and harmonious relationships such as a **Wood Wu Lu** tied with a red ribbon or specific Fire Element items such as a **Cinnabar Egg** or **Red Laughing (Ho Tai) Buddha**.

Coin Swords, 8-Coins on a red string with a tassel, and so forth will stimulate the 8 White Earth to bring financial good fortune. Traditionally, a prosperity symbols like a red **Wealth God, 3-Legged Toad** or **Dragon-headed Tortoise** with

a coin in its mouth is placed in the sector occupied by the Wealth Star 8. Use one or more.

Using Eight Mansion Feng Shui, you can also place any prosperity symbol such as a real **Quartz Crystal Sphere, Wealth Vase, Treasure Ship**, or semi-precious stones, such as a **Citrine Gem Tree** in the Sheng Ch'i direction of your Life Gua (see my **Master Formula Study Guide #1**, see p. 15).

However, the very best wealth energizer is activity. Open windows and let fresh air in. Most important of all, every time you walk through a door or room in this area, think: *ka ching!*

If your bedroom is in the SW, romance images such as a **Dragon and Phoenix** figurine, two **Rose Quartz Hearts**, or a pair of **Mandarin Ducks** will be beneficial for attracting a relationship and for maintaining relationship harmony.

Avoid using items made of metal (other than metal coins and other wealth symbols made of metal), as the Metal Element drains the Earth aspect of Wealth Star 8.

However, caution is also needed in this sector this year, as the 8 White in the SW shares this location with the 15° of Tai Sui, also called the Grand Duke Jupiter.

Grand Duke Jupiter (Tai Sui) in SW

Unfortunately, the #9 shares a 15° portion of its 45° sector of the SW with Tai Sui, also known as Grand Duke Jupiter. Remember, never face the Grand Duke, or disturb this area with digging, remodel-



Hollow Ingot



Abacus



Tibetan Protection Charms



Red Ho Tai



Singing Bowls



Brass Arowana Fish



Tibetan Tingsha



Crystal Sphere

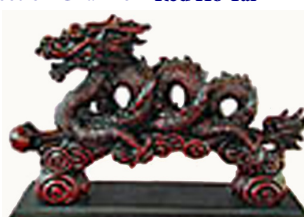

Red Shosan Dragon



Dragon-headed Turtle

eling, or even hammering a nail into a wall to hang a picture. (More on Tai Sui page 6). If you need to mow a lawn or do some construction that includes the SW, begin the project or mowing to either side of the SW3 sector.

If your desk faces this direction, you may want to consider shifting it slightly to avoid the 15° SW3 sector occupied by the Grand Duke, which this year is **232.5° to 247.5°**. If you can not change your desk or other frequently used standing or sitting direction, for protection place a **Pi Yao** or at least a **Dragon headed Tortoise** on the desk, or somewhere in front of you, facing the direction of Tai Sui. Best of all is to sit with your back to the Grand Duke, and **use this energy to support you** in all your endeavors, especially when negotiating, as this will weaken whoever is opposite you, as they will be unwittingly confronting Tai Sui.

Do not put wind chimes, a fan, or any appliances that make noise in this sector this year, which can be difficult if this is your kitchen or TV viewing room. If that is the case, try to position yourself with the Grand Duke behind you, and be sure to place a **Pi Yao** (mythical animal with a dragon-head, horse body, with one or two horns, little wings, and hooves, shown page 6, bottom left; or any fierce looking animal such as a rhinoceros shown bottom, page 9) **in the NE3 sector of the house, or a room, facing the SW3** for protection. Perhaps carry a **Pi Yao Charm** (the Grand Duke's favorite pet) in your pocket, or some other **Pro-**

tection Amulet in accordance to your spiritual belief.

Some authorities recommend a pair of **Pi Yao** be used in order to adequately control Tai Sui. Whether one or two **Pi Yao**, plain or bejeweled, pay attention the first few weeks to see if they are truly protecting you, especially financially.

Li - 9 Purple Fire in East "Star of Future Prosperity"

The 9 Purple Star is the "rising star" of Period 8, and, after 2024, represents the future prosperity and success of your business or career, and is called the Star of Future Prosperity. It is also referred to as the Multiplying Star, as it makes more of whatever it comes in contact with.

The #9 in the East makes this a good area of the house for study or for a bedroom. If a bedroom, placing a **Wood Kuan Yin** statue here will enhance relationship harmony. It is also recommended to place healthy green plants, fresh flowers, or any other symbols of yin-yang harmony to empower relationships, as Wood nourishes Fire.

If your office is situated in the East, for prosperity use red or purple objects, such as an amethyst geod, nine amethyst crystals, or **Amethyst Gem Tree**. A **Scroll with Nine Fish** or nine dragons all strengthen #9's good fortune, while protecting it from negative Monthly Stars.

Avoid using items made of earth, that are square-shaped, or earth tones, as the Earth Element weakens Fire 9.

Water Placement in 2016

Throughout Period 8 (until 2024) **Do Not place water features in the NE**, even if this is the entrance to your home. Water features can be placed outside the home in the SW or East, unless the water feature placed in these directions will activate negative Flying Star combinations in those areas of the home or office.

If you are not sure how to calculate the Flying Star chart for your home, either consult with a feng shui practitioner in your area who is experienced, or contact me, and I will tell you what to send me so I can provide you with an evaluation.

As water can be placed rightly or wrongly based on other formulae, it is advisable to consult with a feng shui practitioner who has experience with Special Water Placement formulae as described in the "Dragon Water Classic."

Preparing for 2016

Along with placing your energized Annual Flying Star Cures, the beginning of the New Year is a good time for a thorough spring cleaning of refrigerator, oven, behind furniture, and so forth. It is also recommended to put fresh paint on the front door, and change the welcome mat or other worn or chipped items if needed. If you could, collect and pay personal debts. Remember to place flowers and bowls of fruit, especially oranges and tangerines, everywhere. Give children red envelopes with money inside. Open windows and welcome the New Year in.



Brass Dragon



3-Legged Toad



Rose Quartz Heart



Pink and Red Crystal Hearts



Qi Lin



Gold Ho Tai



Calligraphy Pen Set



Coin Sword



Ba-gua Mirror



Cinnabar Egg



Blue Glass Rhinoceros



Red Tassels

– Where to Put 2016 Annual Lo Shu Cures –

You can either divide the compass directions of your home using the 9-Box Grid or the 8-Spoked Wheel.

If you are using my perforated **See-Thru 8-Spoked Wheel Tracing Compass**, see instructions below.

If you use the 9-Box Grid method, mark nine boxes on your floor plan and label each box with its compass direction.

For instructions on how to determine the Facing Direction and how to use a Compass to determine the degree of the Facing Direction, see page 16 in my *Tutorial for Using the Master Formula Study Guides*.

Perforated See-Thru 8-Spoked-Wheel Tracing Compass

Designed by Elliot Jay Tanzer

• Instructions •

#1. Using an accurately drawn floor plan, find the center of the house. This can be determined by drawing a line from corner to corner. If the house has an irregular shape, estimate what it would look like if it were square or rectangle (#1A).

#2. Find the mid-point of the Facing of the house and draw a line from the center through the mid-point of the Facing.

#3. Find the compass direction of the Facing of the house.

#4. Place the 8 ½ x 11 **Perforated See-Thru 8-Spoked Wheel Tracing Compass** over the floor plan. Align the center of the Tracing Compass with the center of the floor plan. Using a fine point red pen, put the point through the center perforation on the Tracing Compass and spin the compass until the degree determined by the compass reading in Step #3 is lined up.

#5. Now use the fine point pen and make a dot at each of the 8-compass directions, remove the Tracing Compass, and connect the dots. Write the compass direction outside the floor plan in each of the eight sections.

Now you have a clear idea where to place the enhancements and cures for the Annual Flying Star, or any other Compass School formula, such as might be indicated by the Flying Star number combinations based on Facing Direction and Construction Date (#6), or as required by the Special Water Placement Formulas (#7).

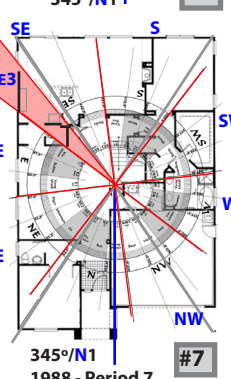
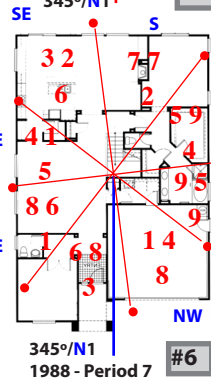
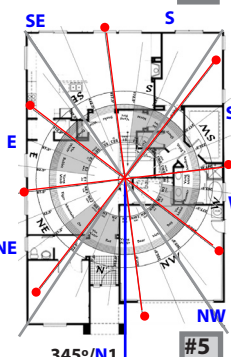
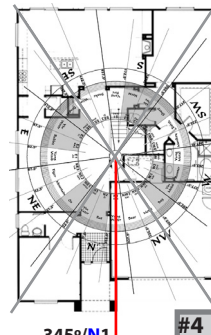
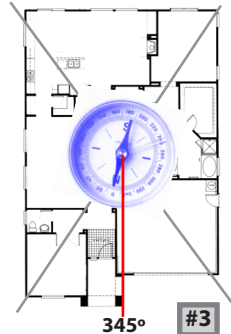
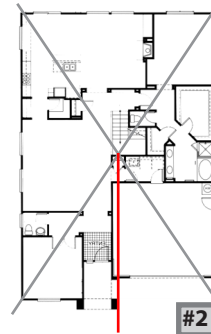
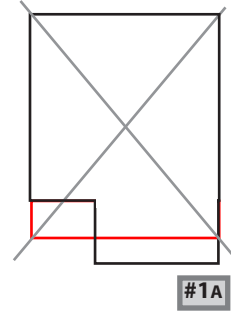
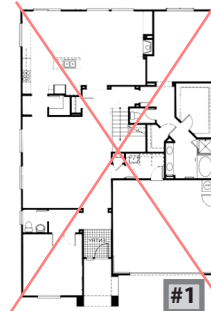

Elliot Jay Tanzer has designed the following awesome Feng Shui books and tools for students and professionals, all available at: www.luckycat.com/cures

Perforated See-Thru 8-Spoked Wheel Tracing Compass – \$20
Gold Card #1: Feng Shui Master Formula Study Guide – \$20
Gold Card #2: Pre-Calculated Flying Star Period Charts 1 - 9 – \$20
Gold Card #3: The Interpretations – \$20
Tutorial for Using the Master Formula Study Guides™ – \$15
Feng Shui Secrets: Improving Health, Wealth & Relationship Harmony – \$19.95



Feng Shui Study Guides Tools for the Feng Shui Practitioner



Designed by Elliot Jay Tanzer

An amazing amount of information on

three 8 1/2 x 11 laminated cards. These laminated Study Guides

are highly recommend for anyone learning and doing Flying Star and Eight Mansion Feng Shui.

GOLD CARD #1 -

Feng Shui Master Formulas

This 8 1/2 x 11 laminated card is an essential tool for any feng shui practitioner doing Flying Star or Eight Mansions Feng Shui. It has everything you need to do a thorough analysis. Both the Solar and Lunar Calendars with their change over dates, Animal Signs and Elements along with the Personal Trigram (Gua) Elements and Numbers all combined in one easy to read reference chart. Plus, the Best and Least Favorable Directions for each Gua Number and all the House Trigram charts are on one side. The reverse side features Flying Star Reigning Period, Annual and Monthly number charts, Lucky and Unlucky Numbers, location of the Three Afflictions, Zodiac Compatibilities, Ba-gua attributes, 24 Directions with degrees and Animal Signs and other reminders which should assist you in integrating Flying Star and other compass techniques into your feng shui practice. I am sure that the more you use this card the more ways you will discover this Study Guide can be used.

GOLD CARD #2 -

Flying Star Charts - Periods 1 - 9

Here you will find all 24 Flying Star Charts pre-calculated for each of the Periods 1 - 9 on one card. Sum of Ten, Parent Strings/Combination of Three, Pearl String, Ho-Tu, Double Facing, Double Sitting, Reverse & Locked Flying Star Charts are all indicated for quick and easy referencing. Replacement Star Chart has been added to the newly revised Gold Card series. Having all the Period 1 - 9 Charts pre-calculated will make your consultations easier and error free.

GOLD CARD #3 -

The Interpretations

Yet another easy to use amassment of useful information at your fingertips. This Study Guide will assist you to quickly reference the interpretations of the Eight Mansions and Flying Star Formulas. Here you will find the meanings of the four Best and four Least Favorable Directions, all 81 Flying Star two-number combinations, the Three Afflictions, the three Five Element Cycles, and much more. All of the essential information needed to interpret Flying Star and Eight Mansion Feng Shui formulas have been carefully collected from many books by Lillian Too, Eva Wong, David Twicken and others. All this and many other reminders on two sides of an 8 1/2 x 11 laminated card.

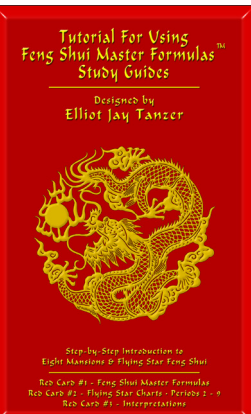
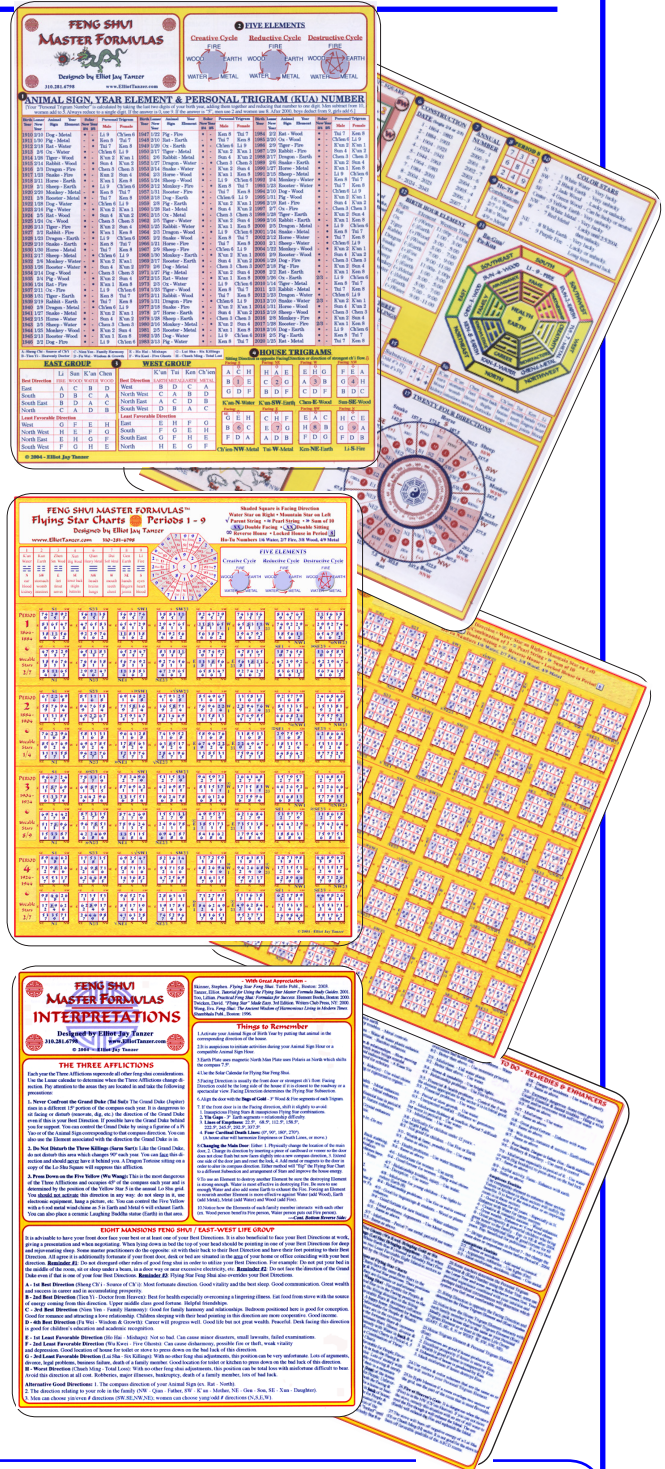

Now Available:

Tutorial for Using Feng Shui Master Formulas Study Guides

- These step-by-step instructions plus the three Study Guides make it easy to learn Eight Mansions and Flying Star Feng Shui. Whether reviewing classes already taken or if you are totally new to this study, this Tutorial will make this ancient art of house analysis easy to master.

Master Formulas Study Guides - \$20.00 each.

The Tutorial - \$15.00.

To order go to:

www.luckyat.com/cures

ASTRO*CARTO*GRAPHY®

GLOBAL FENG SHUI

BY ELLIOT JAY TANZER

Article Reprinted from the Maui Special Edition #2 - Fall 1997 - Stress Free Living Issue

In the previous issue of Maui Special Edition I introduced you to some basic concepts of feng shui (füng sch'way), the art of placement and design. In this issue I would like to share with you an astrological technique that is similar to feng shui called Astro*Carto*Graphy. Where feng shui concerns itself with creating harmony in the immediate home environment by removing obstacles, moving furniture and use of color and symbols, Astro*Carto*Graphy concerns itself to which locations on planet Earth are most harmonious for you to live.

Many of you are familiar with some of the usual ways astrology can be used in self-discovery, understanding relationships, and understanding the changes that happen throughout life (transits and progressions). An Astro*Carto*Graphy Map is a map of the world showing exactly where each planet was passing over at the moment of birth. Through my study of Astro*Carto*Graphy, I have found that different locations have different influence making it easier or more difficult to manifest goals and even to resolve personality and health issues.

Whenever someone is considering moving to a new location, the Astro*Carto*Graphy Map helps to determine the best location to move to. More frequently, I use this chart when an individual seems unhappy where they are and there is no other astrological reasons to explain why life has been so tough for so long. In this situation it usu-

ally turns out the individual is living on an unfavorable planetary line.

The planetary lines that are most favorable are Sun, Jupiter, Venus, Mercury and sometimes, the Moon, The lines that are most difficult are Saturn, Pluto, and sometimes Mars, Uranus and Neptune. Difficult lines can be used to advantage sometimes, and sometimes they are less difficult when combined with a more favorable line.

For example: a Saturn-line may be beneficial for helping some bring structure into their life but once they have their 'act together' the best advice is, "leave." Living on a Saturn-line is much too depressive, burdensome, alienating, lonely and contractive in all areas. Pluto-lines can be even worse. Pluto-lines may begin with a wonderful high, even ecstatic highs, but in short time the crest of the wave gives out and there is a heavy fall. Again the advice is, "leave." Briefly, Mars is too contentious, competitive and masculinizing in a negative sense. Uranus is too erratic, nerve wracking and unpredictable. Neptune is too wishy-washy and rarely sees manifestation. Both Uranus and Neptune may be more creative, spiritual or romantic when combined with a more favorable planet.

The favorable planets bring creativity, popularity, positive relationships, community of like-minded people, sense of well-being, great abundance, and an overall quality of life in how we handle our problems and enjoy our successes.

The First Step-by-Step Tutorial w/ 1-Hour DVD

Evaluating Astro*Carto*Graphy Maps®

by Elliot Jay Tanzer

In this easy to use Step-by-Step Guide with 1-hour DVD, you will learn how to:

- ★ Make accurate measurements.
- ★ Personalize an A*C*G Map to clearly show best and worst areas.
- ★ Interpret a location's influence on health, relationship, and quality of life.
- ★ Transfer the final results onto a World Atlas.

"Elliot[']s book] will be appreciated by many readers, from laypeople...to professional astrologers who want to have more confidence in analyzing A*C*G Maps for their clients."

~~~ Mary Plumb, review in *The Mountain Astrologer*

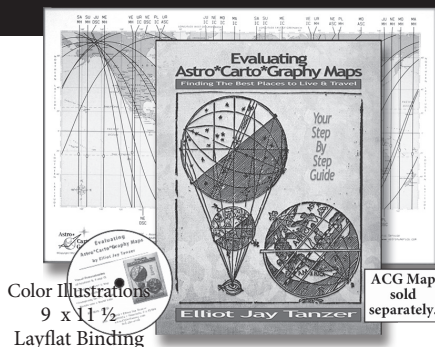

Color Illustrations  
9 x 11 1/2  
Layflat Binding

ACG Map  
sold  
separately.

25% Special Discount for readers of this newsletter • ~~\$49.95~~ \$37 (+\$5 s&h) • To order call: 310-281-6798 or [www.ElliotTanzer.com](http://www.ElliotTanzer.com)



So why would anyone choose anything less than the best planetary lines to live on? Karma of course. Lessons in life that need to be worked through. Where we live fits our patterns. For an individual who has been struggling for years living on a difficult planetary line, looking at an Astro\*Carto\*Graphy Map usually means they are ready to make a conscious choice to live a more harmonious and fulfilling life.

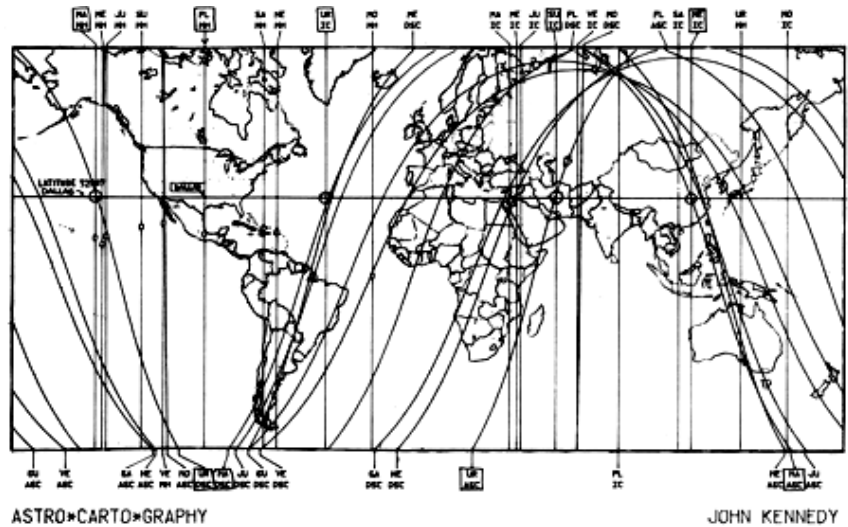

Of course it should be understood that changing the feng shui of your home or moving somewhere else on planet earth doesn't change your core issues – nor is it going to make a short person, tall, or someone with no artistic talent, an artist. However, it should be understood that by making changes on the physical, you set your intention to change on the spiritual. By moving furniture in your home or changing cities you could remove additional frustrations in resolving these core issues sooner, rather than later. For example: an alcoholic in recovery may find more of an inclination to back-slide in certain locations and more support to grow and change in another.

Likewise, it would be folly to think that just because you move to or live on your Venus-line, that relationships will be easy or that you will finally meet your soul-mate. Indeed, if you still haven't resolved your core issues of a need to be in control, or a victim-victimizer issues, or whatever issues you have that have made relationships difficult in the past, you will still have them even on your Venus-line. You may even have a relationship that ends in divorce. However, compared to a Mars-line even the divorce will proceed harmoniously, and you will at least part as friends. Whereas on a Mars-line, the relationship is more likely to end in bitterness and perhaps with a bitter court room battle as well.

For people who travel from location to location, there is another technique called Cyclo\*Carto\*Graphy. This is similar to a transit reading of the birth chart as it shows the changing energy. Former President Carter had Mars

in Iran but it wasn't until Pluto went over Iran that this potential aggression exploded in the hostage controversy. Likewise, Pluto was transiting over Dallas at the time Kennedy was assassinated. For the rest of us mere mortals, the implications are the same. If you travel to a place during a poor transit, you are likely to experience some form of difficulty reflective of your core issues and evolutionary needs. I made the mistake once of traveling to an otherwise joyous Venus location, when Saturn was transiting overhead, and found myself in a serious accident which put me down for three days. Timing can be important.

Unfortunately, not all astrologers, no matter how talented, have the certification training or experience in Astro\*Carto\*Graphy Map interpretation. Nor are the A\*C\*G Maps generated on home computers, as detailed as the professionally plotted 15" x 7 1/2" A\*C\*G Maps available at: [www.astrocartography.co.uk](http://www.astrocartography.co.uk). I have read the A\*C\*G Certification Course and have analyzed over two thousand A\*C\*G Maps, and can answer all your questions concerning where you live, and can help you find those locations that are best for you and your family. ☺

Elliot Jay Tanzer has been providing astrological services since 1973. He is the author of *Feng Shui Secrets: Health, Wealth & Relationship Harmony*, and *Evaluating Astro\*Carto\*Graphy Maps: Finding the Best Places to Live & Travel*. For information about Astrology and Astro\*Carto\*Graphy Map Readings, Feng Shui consultations, or upcoming classes, call Elliot at: (310) 281-6798; or email at: [et@ElliotTanzer.com](mailto:et@ElliotTanzer.com).

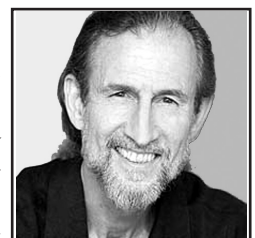

Acknowledgement: Astro\*Carto\*Graphy® Maps was developed by the late astrologer Jim Lewis to whose innovative and inventive Spirit we are greatly indebted.



# Feng Shui Secrets

## Improving Health, Wealth & Relationship Harmony Do Your Own Feng Shui Using the Feng Shui Checklist

**ELLIOT JAY TANZER**

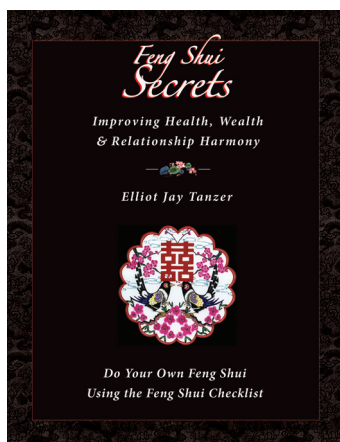

ISBN# 0-9743008-4-9

8 1/2 x 11 – 152 pages

List Price: \$19.95

Order your copy at:  
[www.luckycat.com/cures](http://www.luckycat.com/cures)

*Makes a  
Great Gift  
for Someone  
You Love!*

Check out Elliot's  
Article Archives  
and his new book:

*Evaluating Astro\*Carto\*Graphy  
Maps®: Finding Your Best Places  
to Live & Travel*

at:

[www.ElliotTanzer.com](http://www.ElliotTanzer.com)

### A Unique and Practical Approach to Feng Shui

**Feng Shui Secrets: Improving Health, Wealth & Relationship Harmony** has over 150 illustrated problems and solutions evaluating a house you are buying, renting, or currently living in. The Feng Shui Checklist (pages 19 – 24) is easy for the beginner to use.

- Innovative Checklist format makes it easy for anyone to evaluate a home's good fortune.
- Easy to do solutions that will improve your health and bring greater abundance.
- A valuable resource and textbook for feng shui students and practitioners.
- An indispensable guidebook and reference for real estate agents, home builders, and interior designers.

(3rd revised edition previously titled: *Choose the Best House for You: The Feng Shui Checklist*)

**Feng Shui Secrets: Improving Health, Wealth & Relationship Harmony** is a comprehensive collection of feng shui problems and solutions related to property, house construction, and room configuration with special sections on the entrance, the bedroom and the children's room. Each problem has a page number directing you to the description of the problem, evaluation of difficulty, and suggested solutions.

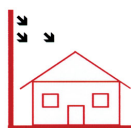

House under cliff p. 29

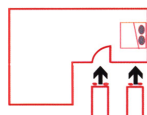

Cars pointing at house p.50

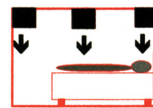

Bed under beam p. 106

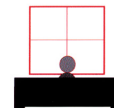

Window behind desk p. 121

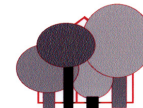

House hidden from view p. 54

#### If you are house hunting:

*Your book has helped tremendously. The checklist format enabled us to quickly assess the big picture and choose the home that was best for us.*

~~Thanks, Elyn Moldow, Colorado

#### If you are a student of feng shui:

*This is an incredible treasure trove of feng shui problems. I learned a lot and have checked it frequently. I can't wait for your next book on interior design.*

~~Thanks, Karen Stover, Maui

**Elliot Jay Tanzer** is the co-founder of the Integrative School of Feng Shui, and has lectured extensively at holistic health and life-style expos, feng shui and astrology conferences, and many metaphysical societies. Elliot is available for astrology and feng shui consultations in person or by telephone. All consultations are recorded. Call or e-mail for more information and to discuss your individual needs:

310.281.6798 or [et@ElliotTanzer.com](mailto:et@ElliotTanzer.com).

